

Models MR-8, R-275, R-315

Residential Gas Meters

MP-1002A R5

SENSUS

Parts List

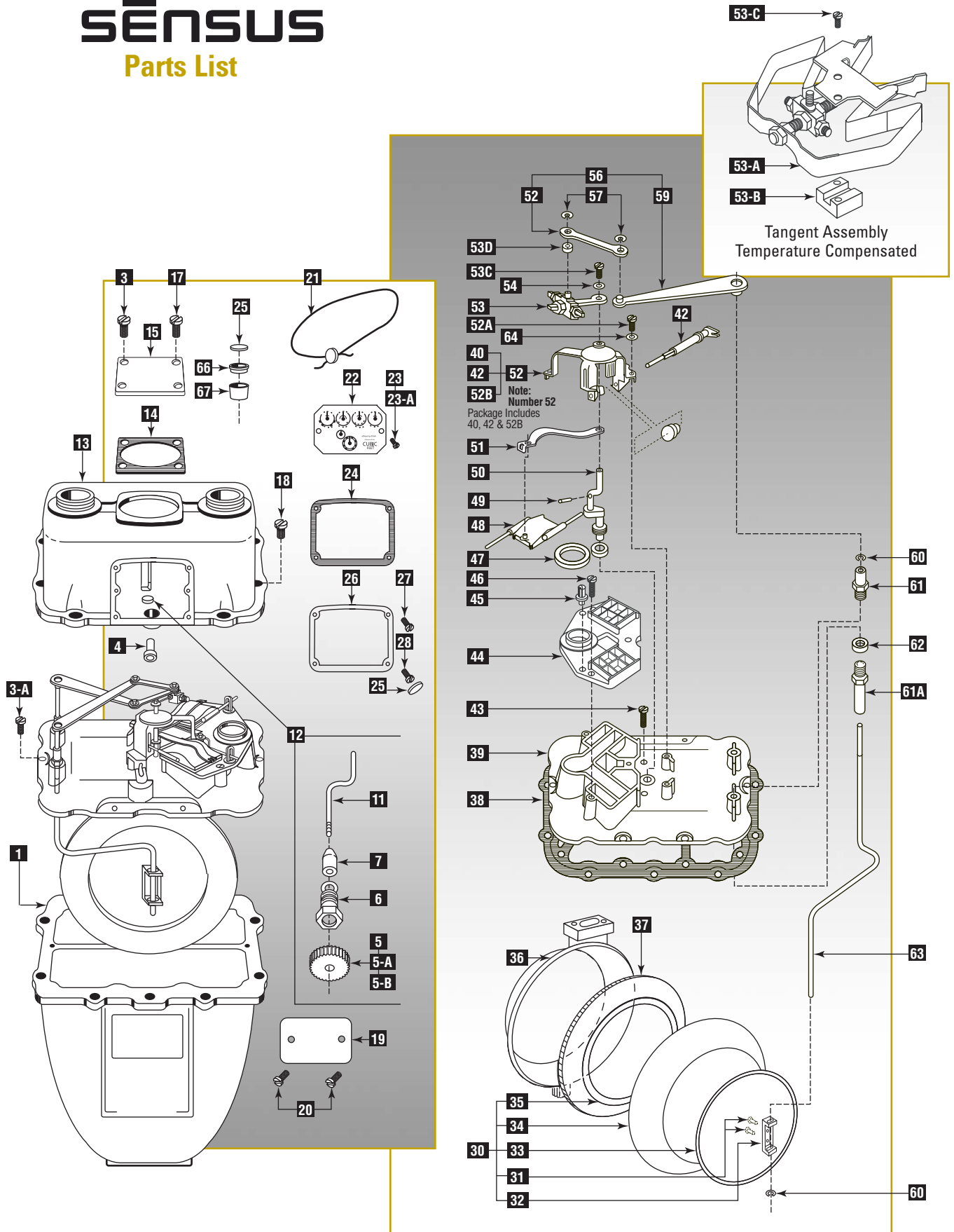

Parts List

Models MR-8, R-275, R-315 Residential Gas Meters



| Illustration Number | Part Description | Part Number MR-8 | Part Number R-275 | Part Number R-315 | |
|---------------------|--|-------------------|-------------------|-------------------|--|
| 1 | Body, No Drains | 001-63-001-29000 | 001-63-001-29000 | 001-63-001-29000 | |
| 2 | Valve Plate Assembly, Uncalibrated, NTC ("EB") | 001-63-502-19000 | 001-63-502-06000 | 001-63-502-06000 | |
| | Valve Plate Assembly, Uncalibrated, TC ("EB") | 001-63-502-20000 | 001-63-502-07000 | 001-63-502-07000 | |
| | Valve Plate Assembly, Uncalibrated, NTC accuWAVE | 001-63-502-86000 | 001-63-502-84000 | | |
| | Valve Plate Assembly, Uncalibrated, TC accuWAVE | 001-63-502-85000 | 001-63-502-83000 | | |
| 3 | Hand Hole Plate Screws, (#10-24 x 5/8") | 950325 | 950325 | 950325 | |
| 3A | Valve Plate Screws, (#10-24 x 7/16") | 950652 | 950652 | 950652 | |
| 4 | Cover Index Shaft Bushing | 001-60-052-62000 | 001-60-052-62000 | 001-60-052-62000 | |
| 5 | Index Shaft Gear (11 Teeth for 2 Ft. Index) | | 001-63-086-03000 | 001-63-086-03000 | |
| 5A | Index Shaft Gear (24 Teeth for 1 Ft. Index) | | 001-63-086-05000 | 001-63-086-05000 | |
| 5B | Index Shaft Gear m ³ | 001-63-086-18000 | | | |
| 6 | Index Shaft Gland | 001-63-023-00000 | 001-63-023-00000 | 001-63-023-00000 | |
| 7 | Index Shaft Seal (Synthetic) | 001-63-350-01000 | 001-63-350-01000 | 001-63-350-01000 | |
| 11 | Stuffing Box Shaft | 001-63-054-05000 | 001-63-054-05000 | 001-63-054-05000 | |
| | Stuffing Box Luubricant | 951139 | 951139 | 951139 | |
| | Stuffing Box Assembly (24 T. Gear for 1 Ft. Index) | | 001-63-423-25000 | 001-63-423-25000 | |
| 12 | Stuffing Box Assembly (11 T. Gear for 2 Ft. Index) | | 001-63-423-22000 | 001-63-423-22000 | |
| | Stuffing Box Assembly (m ³ 16 T) | 00163-423-26000 | | | |
| 13 | Cover Assemblies, 5 psig Test | | | | |
| | Cover Assembly (1-1/4" Spuds, 24 T. Gear for 1 Ft. Index) | | 001-63-203-78000 | 001-63-223-70000 | |
| | Cover Assembly (#1A Sprague, 24 T. Gear for 1 Ft. Index) | | 001-63-203-79000 | 001-63-223-72000 | |
| | Cover Assembly (30 Lt. Spuds, 11 T. Gear for 2 Ft. Index) | | 001-63-203-61000 | 001-63-223-54000 | |
| | Cover Assembly (1-1/4" Spuds, 11 T. Gear for 2 Ft. Index) | | 001-63-203-62000 | 001-63-223-55000 | |
| | Cover Assembly (20 Lt. Spuds, 11 T. Gear for 2 Ft. Index) | | 001-63-203-63000 | 001-63-223-56000 | |
| | Cover Assembly (#2 Sprague, 11 T. Gear for 2 Ft. Index) | | 001-63-203-66000 | 001-63-223-58000 | |
| | Cover Assembly (10 Lt. Spuds, 11 T. Gear for 2 Ft. Index) | | 001-63-203-64000 | 001-63-223-60000 | |
| | Cover Assembly (#1A Sprague, 11 T. Gear for 2 Ft. Index) | | 001-63-203-65000 | 001-63-223-57000 | |
| | Cover Assembly (45 Lt. Spuds, 11 T. Gear for 2 Ft. Index) | | | 001-63-223-59000 | |
| | Cover Assemblky (30 Lt., 24 T. Gear for 1 Ft. Index) | | 001-63-203-81000 | 001-63-223-62000 | |
| | Cover Assembly (20 Lt., 24 T. Gear for 1 Ft. Index) | | 001-63-203-80000 | 001-63-223-64000 | |
| | Cover Assembly (10 Lt., 24 T. Gear for 1 Ft. Index) | | 001-63-203-89000 | 001-63-223-82000 | |
| | | 20 Lt. Cover MR-8 | 001-63-223-00000 | | |
| | | 30 Lt. Cover MR-8 | 001-63-223-01000 | | |
| | | 10 Lt. Cover MR-8 | 001-63-223-02000 | | |
| | | 1-1/4" Cover MR-8 | 001-63-223-04000 | | |
| | #1A Sprague Cover MR-8 | 001-63-223-03000 | | | |
| 14 | Hand Hole Plate Gasket (Cork Rubber) | 001-63-160-50000 | 001-63-160-50000 | 001-63-160-50000 | |
| 15 | Hand Hole Plate | 001-60-004-00000 | 001-60-004-00000 | 001-60-004-00000 | |
| 17 | Hand Hole Plate Screw (#10-24 x 5/8" Fillister Head Drilled) | 001-60-056-06000 | 001-60-056-06000 | 001-60-056-06000 | |
| 18 | Cover Screws (1/4 - 20 x 3/4" Fillister Head Machined) | 950327 | 950327 | 950327 | |
| 19 | Customers Nameplate | 001-41-030-21000 | 001-41-030-21000 | 001-41-030-21000 | |
| | Manufacturers Nameplate, NTC 5# | 001-63-030-76555 | 001-63-030-66555 | 001-63-030-67555 | |
| | Manufacturers Nameplate, TC 5# | 001-63-030-64555 | 001-63-030-64555 | 001-63-030-65555 | |
| | Nameplate accuWAVE NTC 5 lb. | 001-63-034-88555 | 001-63-034-75555 | 001-63-034-76555 | |
| | Nameplate accuWAVE TC 5 lb. | 001-63-034-89555 | 001-63-034-79555 | 001-63-034-80555 | |
| 20 | Drive Screws (Nameplate) 2 x 1/8" | 903003 | 903003 | 903003 | |
| 21 | Seal Wire | 001-63-057-50000 | 001-63-057-50000 | 001-63-057-50000 | |
| | Lead Seal | 001-60-157-00000 | 001-60-157-00000 | 001-60-157-00000 | |

Parts List

Models MR-8, R-275, R-315 Residential Gas Meters



| Illustration Number | Part Description | Part Number MR-8 | Part Number R-275 | Part Number R-315 |
|--------------------------------------|--|------------------|-------------------|-------------------|
| 22 | Index CR 2 ft.- 1/2 ft. Proving Hands NTC | | 001-63-539-05000 | 001-63-593-05000 |
| | Index DR 2 ft.- 1/2 ft. Proving Hands NTC | | 001-63-538-68000 | 001-63-538-68000 |
| | Index CR 2 ft.- 1/2 ft. Proving Hands TC | | 001-63-539-15000 | 001-63-539-15000 |
| | Index DR 2 ft. - 1/2 ft. Proving Hand TC | | 001-63-538-69000 | 002-63-539-69000 |
| | Index DR 1 ft. Proving Hand 4 Wheel NTC | | 001-63-538-66000 | 001-63-538-66000 |
| | Index DR 1 ft. Proving Hand 4 Wheel TC | | 001-63-538-67000 | 001-63-538-67000 |
| | Index .05 m ³ TC 6 Wheel | 001-63-538-65000 | | |
| Index .05 m ³ NTC 6 Wheel | 001-63-538-64000 | | | |
| 23 | Index Mounting Screws (#6-32 x 1/2" Fillister Head) All Brass | 919656 | 919656 | 919656 |
| 23A | Index Mounting Screws (#6-32 x 5/8" Fillister Head) All Plastic | 919657 | 919657 | 919657 |
| 23B | Spacer for Brass D.R. Index | 001-60-197-61000 | 001-60-197-61000 | 001-60-197-61000 |
| 24 | Index Box Gasket (Cork Rubber) | 001-63-170-02000 | 001-63-170-02000 | 001-63-170-02000 |
| 25 | Rockseal | 001-63-056-05000 | 001-63-056-05000 | 001-63-056-05000 |
| 26 | Index Box, Molded Lexan with vents | 001-63-006-05000 | 001-63-006-05000 | 001-63-006-05000 |
| 27 | Index Box Seal Screw (#10-24 x 11/16" Fillister Head Steel, Drilled) | 001-63-056-06000 | 001-63-056-06000 | 001-63-056-06000 |
| 28 | Index Box Screw (#10-24 x 11/16" Fillister Head Steel) | 950525 | 950525 | 950525 |
| 30 | Diaphragm Assembly Right Hand (Synthetic) Standard "EB" | 001-63-551-72000 | 001-63-551-72000 | 001-63-551-72000 |
| | Diaphragm Assembly Left Hand (Synthetic) Standard "EB" | 001-63-651-72000 | 001-63-651-72000 | 001-63-651-72000 |
| | Diaphragm Assembly Right Hand accuWAVE | 001-63-551-75000 | 001-63-551-75000 | 001-63-551-75000 |
| | Diaphragm Assembly Left Hand accuWAVE | 001-63-651-75000 | 001-63-651-75000 | 001-63-651-75000 |
| 31 | Diaphragm Bracket Rivet (.098 x 5/32") | | | |
| 32 | Diaphragm Bracket | | | |
| 33 | Diaphragm Disc, Outer | | | |
| 34 | Diaphragm | | | |
| 35 | Diaphragm Disc, Inner | | | |
| | Diaphragm and Disc Assembly | | | |
| 36 | Diaphragm Pan Assembly Right Hand | | | |
| | Diaphragm Pan Assembly left Hand | | | |
| 37 | Diaphragm Clamping Ring | | | |
| 38 | Cover Gasket C.R. | 001-63-164-50000 | 001-63-164-50000 | 001-63-164-50000 |
| 39 | Valve Plate (See Valve Plate and Seat Assembly, Item 65) | | | |
| 40 | Index Shaft Worm Wheel | 001-63-035-05000 | 001-63-035-01000 | 001-63-035-01000 |
| 42 | Index Shaft Only | 001-63-054-08000 | 001-63-054-03000 | 001-63-054-03000 |
| 43 | Diaphragm Screws (#10-24 x 1" Fillister Head Machine w/washer | 001-63-119-00000 | 001-63-119-00000 | 001-63-119-00000 |
| 44 | Valve Seat (See Valve Plate and Seat Assembly, Item 65) | | | |
| 45 | Valve Guide | 001-63-114-00000 | 001-63-114-00000 | 001-63-114-00000 |
| 46 | Valve Seat Screws (#10-24 x 7/16" Type I Cross Recessed Pan) | 950652 | 950652 | 950652 |
| 47 | Exhaust Seal Washer | 001-63-134-00000 | 001-63-134-00000 | 001-63-134-00000 |
| 48 | Valve (RH LH) KIT (Bakelite) | 001-63-405-04000 | 001-63-405-04000 | 001-63-405-04000 |
| 50 | Plastic Crank and Worm Assembly, NTC | 001-63-016-64000 | 00163-016-62000 | 00163-016-62000 |
| | Plastic Crank and Worm Assembly, TC | 001-63-016-63000 | 001-63-016-61000 | 001-63-016-61000 |
| | Crank and Bracket Assembly, NTC | 001-63-504-89000 | 001-63-504-88000 | 001-63-504-88000 |
| | Crank and Bracket Assembly, TC | 001-63-504-97000 | 001-63-504-91000 | 001-63-504-91000 |
| 50A | Crank Bushing (Powdered Iron) | | 001-60-065-03000 | 001-60-065-03000 |
| 51 | Valve Link (Plastic Crank) | 001-63-022-05000 | 001-63-022-05000 | 001-63-022-05000 |
| 52A | Crank Bracket Screw (#8-32 x 7/16" Fillister Head Machine) | 919704 | 919704 | 919704 |
| 52B | Crank Bracket (Plastic Crank) | 001-63-104-02000 | 001-63-104-02000 | 001-63-104-02000 |

(continued on back cover)

Parts List

Models MR-8, R-275, R-315 Residential Gas Meters



Authorized Distributor:

805 Liberty Boulevard
 DuBois, PA 15801
 800-375-8875
 Fax: (814) 375-8460
www.sensus.com/gas

| Illustration Number | Part Description | Part Number MR-8 | Part Number R-275 | Part Number R-315 |
|---------------------|---|------------------|-------------------|-------------------|
| 53 | Tangent Assembly, NTC (Includes 53D, 57) | 001-61-513-22000 | 001-61-513-22000 | 001-61-513-22000 |
| | Tangent Post, NTC and TC | 001-63-045-03000 | 001-63-045-03000 | 001-63-045-03000 |
| | Tangent Lock Nut | 001-61-266-00000 | 001-61-266-00000 | 001-61-266-00000 |
| | Tangent Locknut, Thin | 001-63-266-03000 | 001-63-266-03000 | 001-63-266-03000 |
| | Tangent Adjusting Screw | 001-63-046-00000 | 001-63-046-00000 | 001-63-046-00000 |
| | Tangent Arm | 001-63-013-02000 | 001-63-013-02000 | 00163-013-02000 |
| 53A | Tangent Assembly, TC | | | |
| | 53C, 53B, 57, 53D | 001-63-513-08000 | 001-63-513-08000 | 001-63-513-08000 |
| 53B | Tangent Mounting Block, TC | 001-63-294-05000 | 001-63-294-05000 | 001-63-294-05000 |
| 53C | Tangent Mounting Block Screws, TC | | | |
| | (#3-56 x 3/16" Binder Head, Stainless Steel) | 950433 | 950433 | 950433 |
| 53D | Bushing | 001-63-048-01000 | 001-63-048-01000 | 001-63-048-01000 |
| 54 | Washer Brass | 951487 | 951487 | 951487 |
| 56 | Flag Arm and Link Assembly Right Hand (Includes 57, 58, 59) | 001-63-511-04000 | 001-63-511-02000 | 001-63-511-02000 |
| | Flag Arm and Link Assembly left Hand (Includes 57, 58, 59) | 001-63-611-04000 | 001-63-611-02000 | 001-63-611-02000 |
| 57 | Flag Arm Snap Ring | 902439 | 902439 | 902439 |
| 58 | Tangent Links Nylon | 00163-020-03000 | 001-63-020-02000 | 001-63-020-02000 |
| 59 | Flag Arm and Stud Right Hand | 001-63-211-00000 | 001-63-211-00000 | 001-63-211-00000 |
| | Flag Arm and Stud left Hand | 001-63-311-00000 | 001-63-311-00000 | 001-63-311-00000 |
| 60 | Flag Rod Retaining Clips | 904680 | 904680 | 904680 |
| 61 | Flag Rod Gland (Upper) | 001-63-012-01000 | 001-63-012-01000 | 001-63-012-01000 |
| 61A | Flag Rod Gland (Lower) | 001-60-012-02000 | 001-60-012-02000 | 001-60-012-02000 |
| 62 | Flag Rod Seal (V Seal) | 001-63-276-00000 | 001-63-276-00000 | 001-63-276-00000 |
| 63 | Flag Right Hand | 001-63-142-06000 | 001-63-142-06000 | 001-63-142-06000 |
| | Flag left Hand | 001-63-342-06000 | 001-63-342-06000 | 001-63-342-06000 |
| 65 | Valve Plate and Seat Assembly | | | |
| | (Includes 39, 44, 50A, 61, 61A, 62) | 001-63-602-13000 | 001-63-602-13000 | 001-63-602-13000 |
| 66 | Spacer Bushing Rockseal | 001-63-053-01000 | 001-63-053-01000 | 001-63-053-01000 |
| 67 | Snap Cup Rockseal | 001-63-057-02000 | 001-63-057-02000 | 001-63-057-02000 |
| 68 | Tangent Screw to Crank | 951509 | 951509 | 951509 |

| Part Description | Part Number MR-8 | Part Number R-275 | Part Number R-315 |
|--------------------------------------|------------------|-------------------|-------------------|
| Crank and Bracket Assembly, NTC Test | | 001-63-504-31000 | 001-63-504-31000 |
| Crank and Bracket Assembly, TC Test | 001-63-504-24000 | 001-63-504-36000 | 001-63-504-36000 |
| Stuffing Box Gear (20T) | | 001-63-086-08000 | |
| Stuffing Box Gear (30T) | 001-63-086-16000 | | |
| Test Meter Index | 001-63-538-93000 | 001-63-537-83000 | |

Limited Warranty

Seller warrants the Goods to be free from defects in materials manufactured by Seller and in Seller's workmanship for a period of one (1) year after tender of delivery (the "Warranty Period"). THIS LIMITED WARRANTY (a) IS IN LIEU OF, AND SELLER DISCLAIMS AND EXCLUDES ALL OTHER WARRANTIES, STATUTORY, EXPRESS OR IMPLIED, INCLUDING, WITH LIMITATION, ANY WARRANTY OF MERCHANTABILITY OR FITNESS FOR A PARTICULAR PURPOSE, OR OF CONFORMITY TO MODELS OR SAMPLES; (b) does not apply to any Goods which have been (i) repaired, altered or improperly installed; (ii) subjected to improper use or storage, (iii) used or incorporated with other materials or equipment, after buyer or anyone using the Goods has, or reasonably should have, knowledge of any defect or nonconformance of the Goods; or (iv) manufactured, fabricated or assembled by anyone other than Seller, (c) shall not be effective unless buyer notifies Seller in writing of any purported defect or nonconformance with (thirty days) after Buyer discovers or should have reasonably discovered such purported defect or nonconformance; and (d) shall only extend to Buyer and not to any subsequent buyers or users of the Goods. Buyer shall provide Seller access to the Goods as to which Buyer claims a purported defect or nonconformance, upon request by Seller, buyer shall, at its own risk and expense, promptly return the Goods in question to Seller's Plant.